

Shepard B25

Room Configuration/Set-Up Options

Shepard B25
Option A - Meeting
Capacity: 36

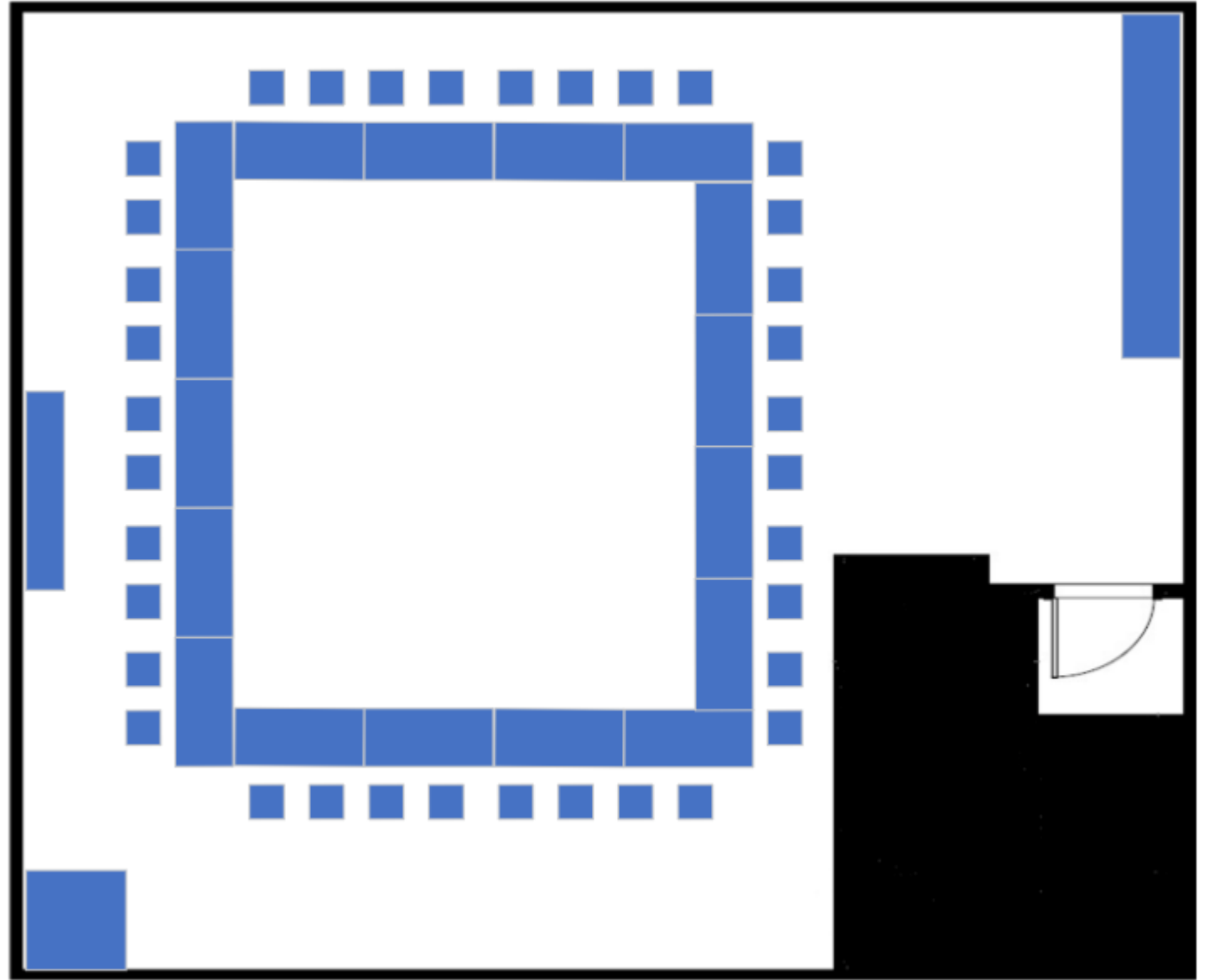

Shepard B25
Option B - Presentation
Capacity: 50

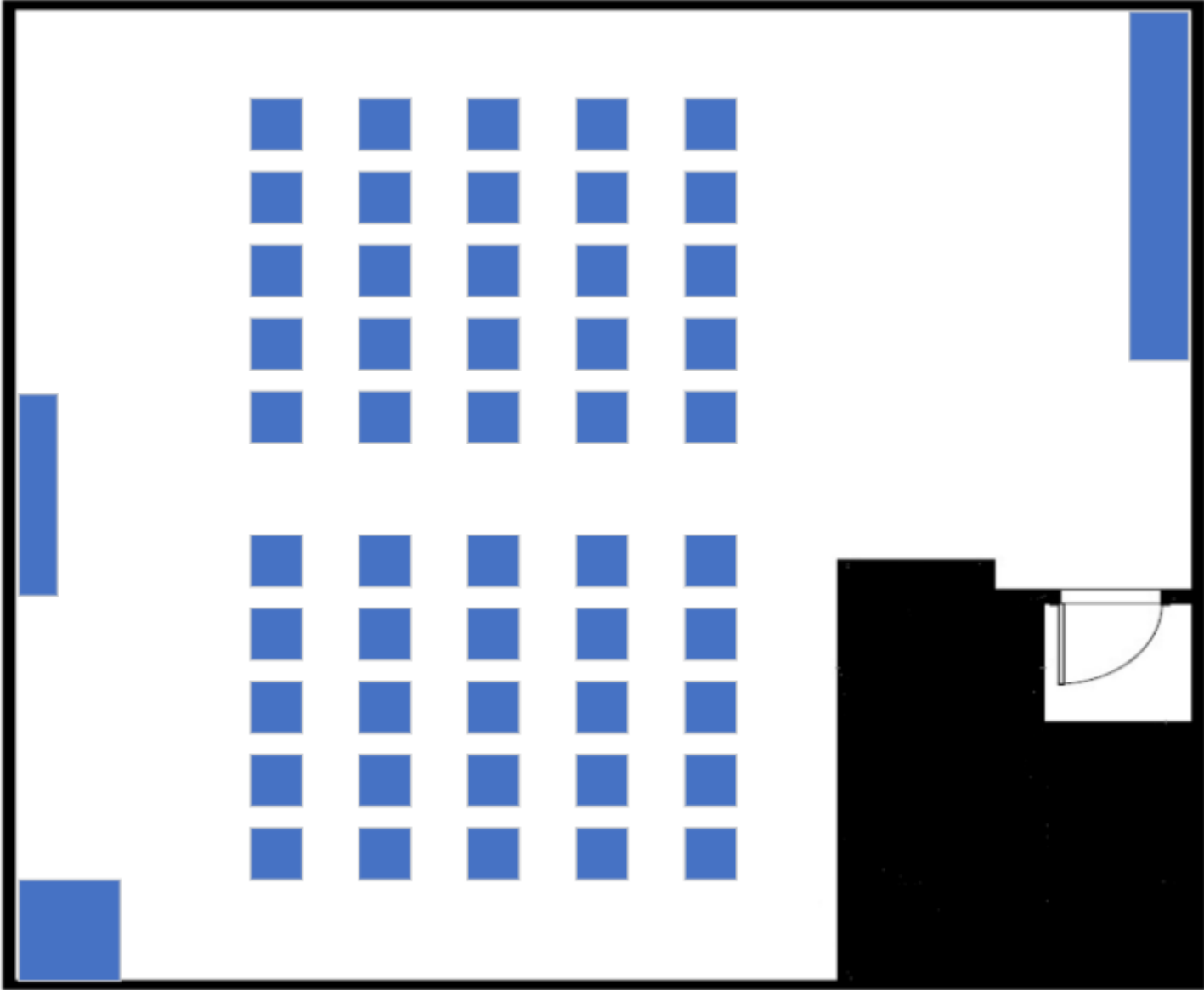

Shepard B25
Option C - Lecture
Capacity: 44

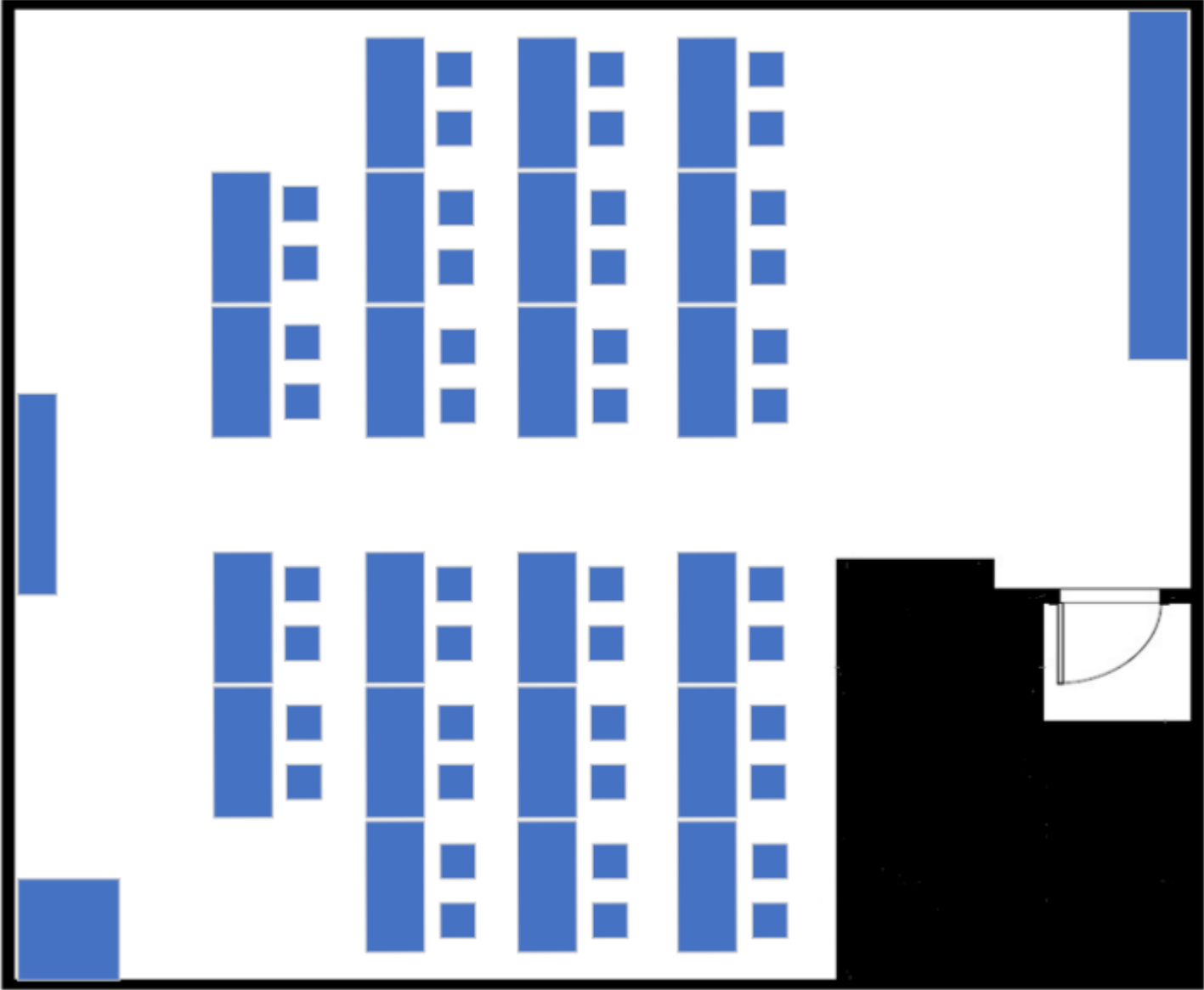

Shepard B25
Option D - Pods
Capacity: 42

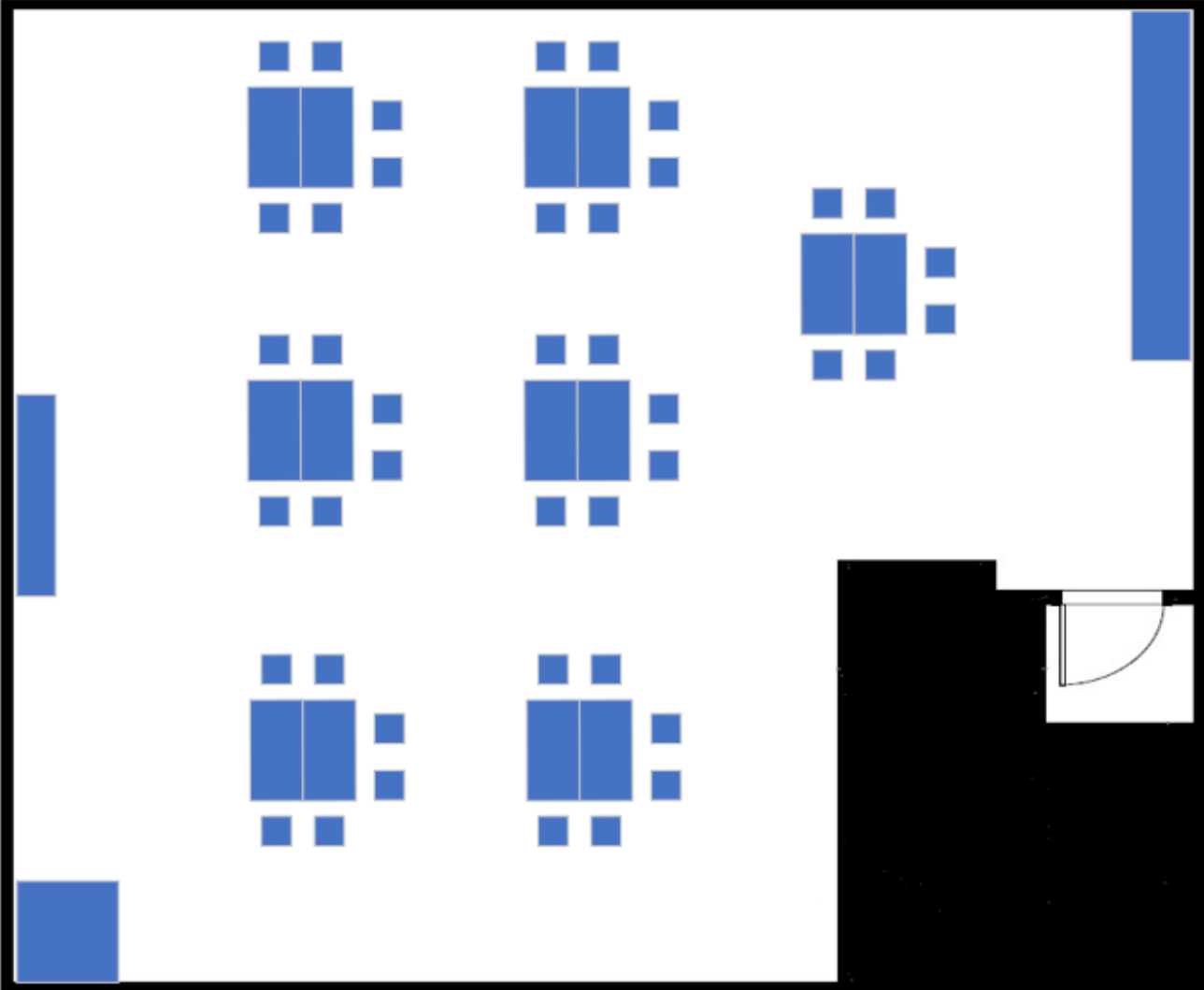

Shepard B25
Option E – U Shape
Capacity: 26

